

fitting instructions for roller blinds

Step 1

Outside Recess

If the blind is to be fitted outside the window, ensure that measurement **C** is the same. **C** is simply equal to **A** minus **B**, divided by two. Follow instructions for FACE FIXING.

Inside Recess

If TOP FIXING, fix to the lintel if the window frame is uPVC, or if there are no obstructions. If FACE FIXING, fit bracket to the window frame.

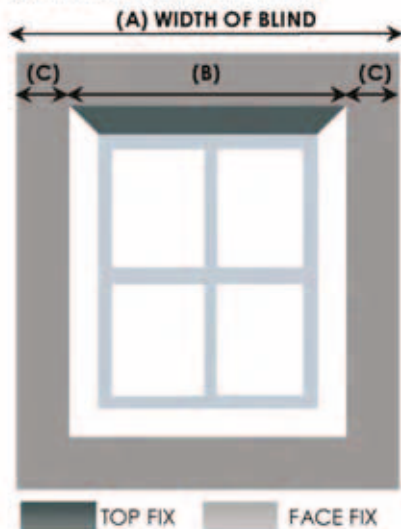

Step 2

Hold each bracket into place and mark the hole positions. Fit each bracket using 2 screws provided.

TOP FIXING



FACE FIXING



Step 3

Holding the fully-wound blind, insert the idle pin end into the bracket as shown.

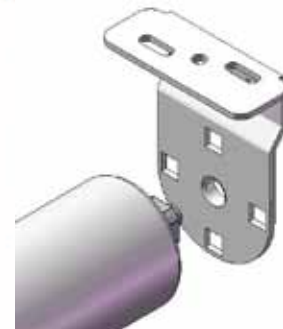

With the idle pin end in place, insert the control end into the opposite bracket. Ensure that the blind has clicked into place using the centre lug.

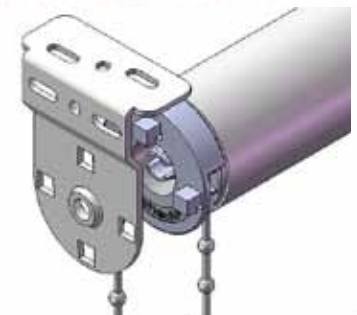

Step 4

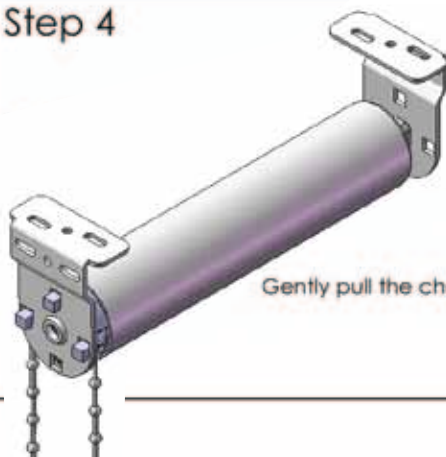

Gently pull the chain to raise and lower the blind.

Safety Cleat Fitting Instructions

Step 1

- Place safety cleat in the desired location on the wall and mark the position of the two holes using a pencil.
- We recommend position the cleat to either side of the blind and out of the reach of children.

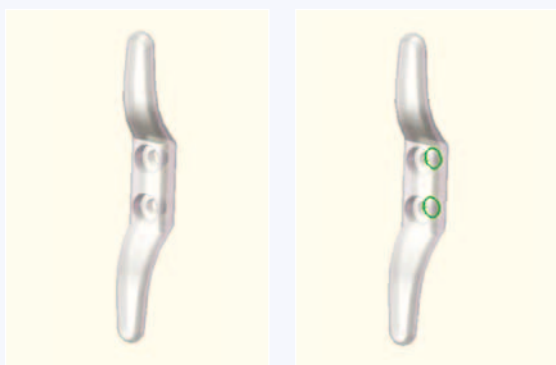

Step 2

- Remove the safety cleat and drill the positions marked.
- Once the holes are drilled place a Rawlplug into the holes.
- Use the screws provided to attach the safety cleat to the wall.

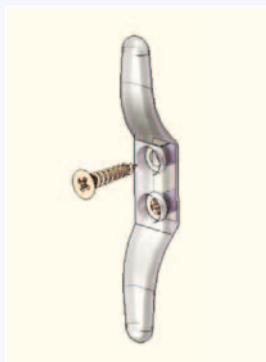

Step 3

- We recommend that the cord is wrapped around the safety cleat when the blind is not in use, as shown in the pictures below.

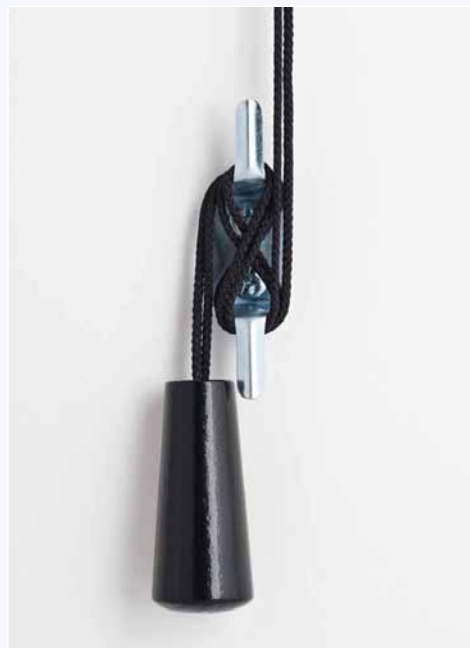

WARNING

Young children can strangle in the loop of pull cords, chains, tapes that operate window coverings. They can also wrap the cords around their necks. To avoid the risk of strangulation and entanglement, keep cords out of the reach of young children. Move beds, cots and furniture away from window covering cords.

